

DS-12

Dynamics series



FEATURES

- » 2-way vented loudspeaker system
- » 12" speaker
- » 1" compression driver with constant directivity horn
- » 300 W power handling
- » Highly resistant polypropylene enclosure

SPECIFICATIONS

RMS (Average) Power Handling^a:	300 W
Program Power Handling^b:	600 W
Peak Power Handling^c:	1200 W
On-axis Frequency Range^d:	55 Hz - 20 kHz
Nominal Impedance:	8 Ω
Minimum Impedance:	6.5 Ω (at 8.5 kHz)
On-axis Sensitivity 1W / 1 m^e:	98 dB SPL
Rated Peak SPL at Full Power:	129 dB
Nominal -6 dB Beamwidths^f:	105° Horizontal
(average, 500 Hz to 8 kHz)	75° Vertical
Speech Coverage Angles^g:	110° Horizontal x 85° Vertical
Enclosure Material:	Mineral loaded polypropylene
Color:	Black or white
Transducers/Replacement Parts:	Low: P-12/GM P-12 High: M-3/GM M-5
Connector:	2 paralleled NL4 Speakon, wired to ±1
Dimensions (H x W x D):	58 x 40 x 31 cm (23 x 16 x 12 in)
Weight:	17.8 kg (39 lbs)
Shipping Weight:	20 kg (44 lbs)
Accessories (optional):	AX-12/15 wall mounting bracket TRD-2 adjustable tripod ANL-1 hanging rings FUN-12 padded transport cover

INTRODUCTION

The D.A.S. DS-12 is a versatile high efficiency 2-way vented loudspeaker system.

APPLICATIONS

Intended for use in fixed and portable sound reinforcement, musical instruments, discos, clubs.

DESCRIPTION

The low end utilizes a high efficiency 12" low frequency speaker with 3" voice coil.

The high end makes use of a 1" exit compression driver with 2" titanium diaphragm, coupled to a constant directivity horn.

Full use of high pressure injection moulding techniques has achieved a mineral loaded polypropylene cabinet of a very high density. Internal design provides extensive wall reinforcing for minimum vibration. A moulded-in handle facilitates carrying.

For added resistance, rugged steel grilles protect the components.

MOUNTING

A range of optional accessories is available: adjustable wall mounting brackets, tripods and hanging rings provide comprehensive mounting.

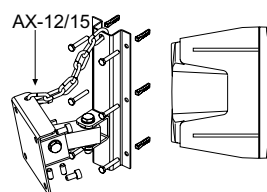
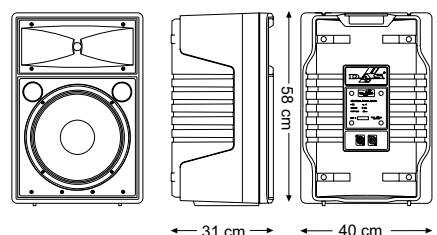

^a Based on a 2 hour test using a 6 dB crest factor pink noise signal bandlimited according to IEC 268-1 (1985). All power ratings are referred to the nominal impedance.

^b Conventionally 3 dB higher than the RMS measure, although this already utilizes a program signal.

^c Corresponds to the signal crests for the test described in^a.

^d As per IEC 268-5 (1989), re. a one octave band centred at 2 kHz. Half space anechoic.

^e In practice cable and connector impedance has to be added to all impedance values.

^f For the 2 kHz one octave band.

^g Average of one-third octave band measures.

^h There is currently no standard method of averaging the beamwidth with frequency characteristics into a single meaningful figure, which impedes comparisons across manufacturers and very often even product lines. This, our own, criterion weighs the -6 dB coverage angles from one-octave bands according to their contribution to speech intelligibility.

One and one-third octave bands comply to ANSI S1.11-1986.

FREQUENCY RESPONSE

Figure 1 shows the frequency response at 1 m of a unit radiating to a half space anechoic environment and driven by a 1 W (2.83 V) swept sine signal.

IMPEDANCE

Figure 2 shows impedance with frequency.

DISTORTION

Figure 3 shows the Total Harmonic Distortion Plus Noise (solid), Second Harmonic Distortion (grey) and Third Harmonic Distortion (dotted) curves for a unit driven at 10% of its nominal power handling rating.

BEAMWIDTH

Figure 4 shows the -3, -6 and -10 dB horizontal (solid) and vertical (dashed) beamwidth with frequency curves. -6 dB ones are shown with thicker traces for clarity.

AXIAL DIRECTIVITY $Q(R_0)$ AND D_i

Figure 5 shows the above characteristics with frequency. Thin continuous and dashed lines show partial horizontal and vertical, respectively, characteristics.

POLAR RESPONSE

Figure 6 shows the one octave band horizontal (solid) and vertical (dashed) polars for the indicated frequencies. Full scale is 50 dB, 5 dB per division.

NOTES. 1.Frequency response: referred to 1 m; low end obtained through the use of near field techniques; one-third octave smoothed for correlation with human hearing. 2.In practice, cable and connector impedance need to be added. 3.Harmonic distortion components are not plotted beyond 20 kHz; near-field techniques used. 4.Directivity characteristics plotted with respect to frequency are the average within the one-third octave bands of center frequencies noted by the marks at the bottom of the graphs, but are joined up for display purposes. All other characteristics plotted vs. frequency use 1/24th octave resolution. Regions of less than 1 dB below goal level and sharp notches may be ignored when calculating beamwidths. 5.Directivity factor and index were computed from two degree resolution vertical and horizontal polars using sinusoidal weighting. 6.Polars were acquired by placing the unit on a computer controlled turntable inside our anechoic chamber. Measurement distance was 4 m.

Product improvement through research and development is a continuous process at D.A.S. Audio. All specifications subject to change without notice.

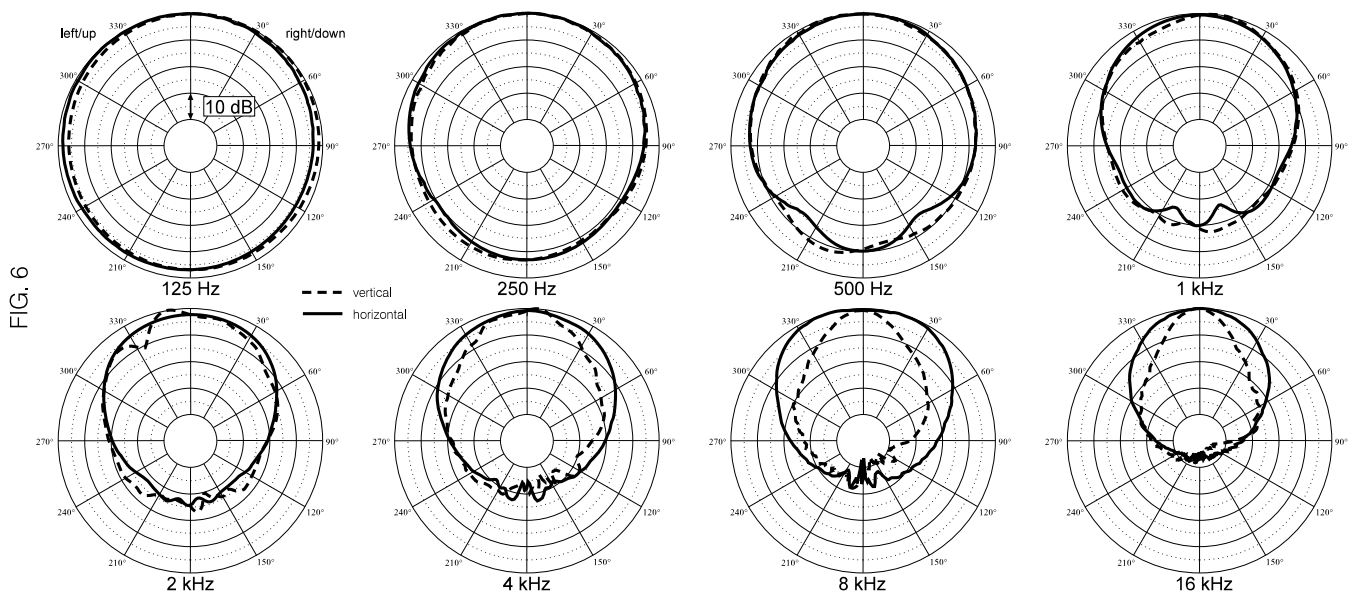
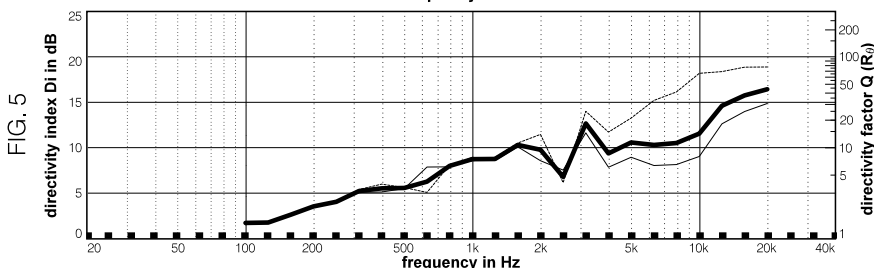
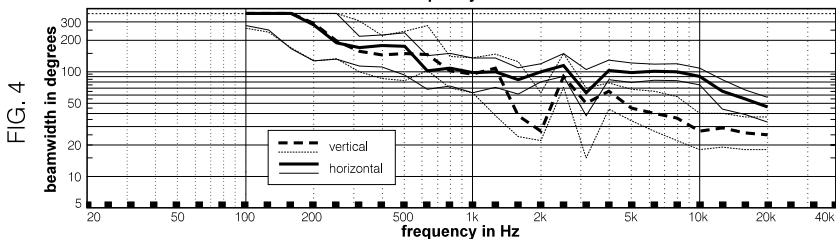
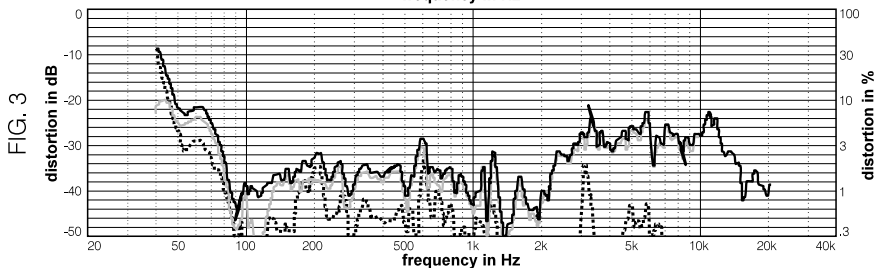
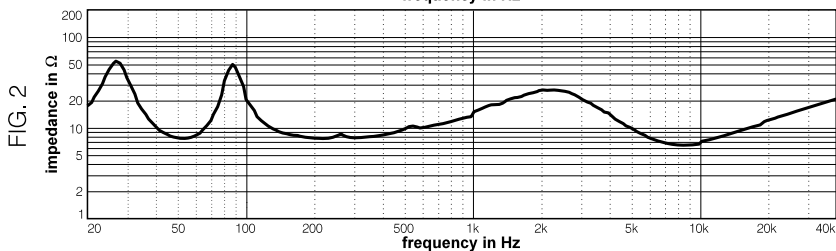
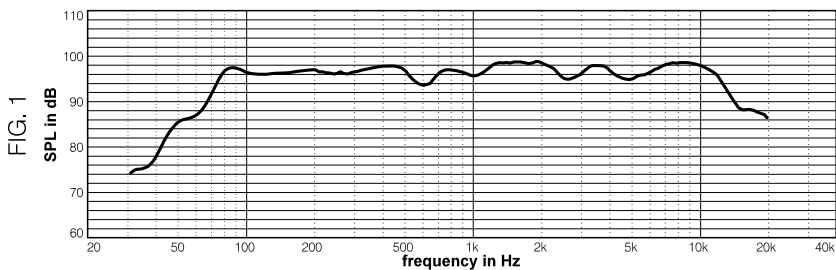

D.A.S. Audio, S.A.

C/. Islas Baleares, 24 - 46988 Fuente del Jarro - Valencia, SPAIN

Tel. 96 134 0525 - Tel. Intl. +34 96 134 0860 - Fax. 96 134 0607 - Fax. Intl. +34 96 134 06 07

D.A.S. Audio of
America, Inc.

6970 N.W. 50th St. Miami, FL 33166, U.S.A.

Tel. +1 305 436 0521 - Fax. +1 305 436 0528

<http://www.dasaudio.com>